

EMERY™ A1 24V Linear Lighting Fixture

A deep, architectural-grade fixture with an integrated wire raceway.

Date _____

Project Notes _____



FEATURES	MECHANICAL DIAGRAM
<ul style="list-style-type: none"> Surface mount with hidden wire raceway Assembled in the USA Multiple output options Architectural lens IP20 (Indoor / Damp Location) Closet rated SS: 12 Year Warranty / VE & STD: 7 Year Warranty 	

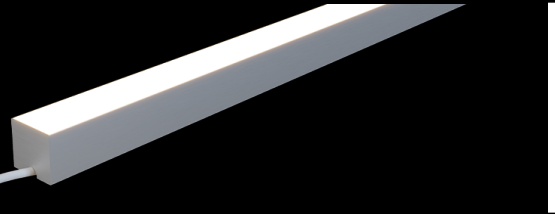

ORDERING CODES

Order customized fixture								Options 9 - 13 are not required to create a fixture.					
1	2	3	4	5	6	7	8	9	10	11	12	13	14
Product	Finish	Rating	Performance	W/ft.	CCT	Lens	Fixture Length	Exact / Optimal	Input Wire Length	Input Wire Color, Type & Connection	Output Wire Length	Output Wire Color, Type & Connection	Mounting
DI													

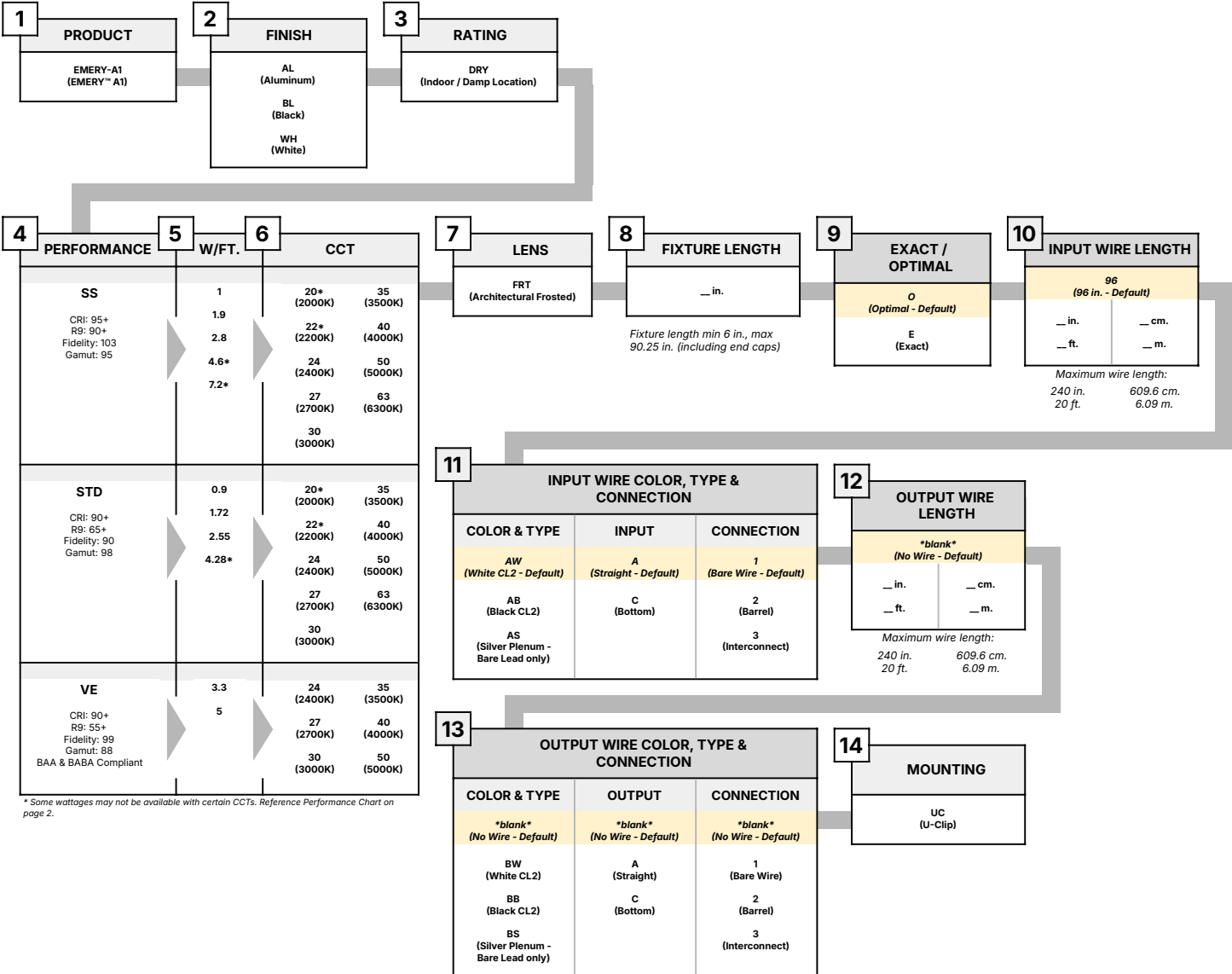

* Some wattages may not be available with certain CCTs. Reference Performance Chart on page 2.

EMERY™ A1 24V Linear Lighting Fixture

A deep, architectural-grade fixture with an integrated wire raceway.

Date _____

Project Notes _____



SS Performance

Wattage	CCT	Arch Frosted
1 W/ft.	2000K	73
	2200K	73
	2400K	73
	2700K	71
	3000K	74
	3500K	76
	4000K	78
	5000K	81
6300K	78	
1.9 W/ft.	2000K	136
	2200K	136
	2400K	136
	2700K	145
	3000K	153
	3500K	153
	4000K	160
	5000K	169
6300K	171	
2.8 W/ft.	2000K	209
	2200K	209
	2400K	209
	2700K	218
	3000K	226
	3500K	230
	4000K	239
	5000K	256
6300K	254	
4.6* W/ft.	2000K	-
	2200K	-
	2400K	328
	2700K	347
	3000K	390
	3500K	410
	4000K	374
	5000K	414
6300K	405	
7.2* W/ft.	2000K	-
	2200K	-
	2400K	511
	2700K	547
	3000K	597
	3500K	634
	4000K	564
	5000K	588
6300K	647	

STD Performance

Wattage	CCT	Arch Frosted
0.9 W/ft.	2000K	64
	2200K	67
	2400K	72
	2700K	81
	3000K	75
	3500K	77
	4000K	76
	5000K	72
6300K	76	
1.72 W/ft.	2000K	134
	2200K	137
	2400K	144
	2700K	155
	3000K	155
	3500K	144
	4000K	146
	5000K	144
6300K	146	
2.55 W/ft.	2000K	200
	2200K	204
	2400K	214
	2700K	228
	3000K	230
	3500K	209
	4000K	219
	5000K	211
6300K	214	
4.28* W/ft.	2000K	-
	2200K	-
	2400K	354
	2700K	377
	3000K	353
	3500K	354
	4000K	358
	5000K	354
6300K	358	

VE Performance

Wattage	CCT	Arch Frosted
3.3 W/ft.	2400K	175
	2700K	202
	3000K	204
	3500K	200
	4000K	226
5000K	231	
5 W/ft.	2400K	273
	2700K	281
	3000K	286
	3500K	295
	4000K	326
5000K	333	

EMERY™ A1 24V
Linear Lighting Fixture

A deep, architectural-grade fixture with an integrated wire raceway.

Date _____

Project Notes _____



A1 FIXTURE DIFFUSION



MOUNTING OPTIONS

U-Clip

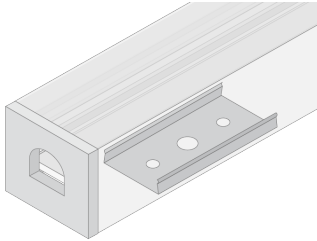

U-Clip Total Dimensions:
0.64 × 0.64 (H x W)

EMERY™ A1 24V Linear Lighting Fixture

A deep, architectural-grade fixture with an integrated wire raceway.

Date _____

Project Notes _____



RECOMMENDED 24V DRIVERS

SKU	INPUT VOLTAGE / FREQUENCY	OUTPUT VOLTAGE	MAXIMUM LOAD	MINIMUM LOAD	CLASS 2	DIMMABLE	LENGTH	WIDTH	HEIGHT
OMNIDRIVE® X Dimmable Driver OMNIDRIVE® X Dimmable Driver Specification Sheet Versatile driver for most high-performance dimming on ELV, TRIAC, and 0-10V systems. https://www.diodeled.com/custom/download/productFile/filename/omnidrive-x-specification-sheet.pdf/ Contains: • Additional Models • Derating Curves • Additional Features • System Diagrams									
DI-ODX-24V30W-J	120-277V	24V	30W	No Minimum Load	Yes	Yes	6.5 in.	3.7 in.	1.57 in.
DI-ODX-24V60W-J	120-277V	24V	60W	No Minimum Load	Yes	Yes	7.4 in.	3.7 in.	1.57 in.
DI-ODX-24V96W-J	120-277V	24V	96W	No Minimum Load	Yes	Yes	8.66 in.	3.7 in.	1.57 in.
DI-ODX-24V120W-J	120-277V	24V	120W	No Minimum Load	No	Yes	8.66 in.	3.7 in.	1.57 in.
VLM Series Constant Voltage Driver VLM Series Constant Voltage Driver Specification Sheet Compact driver for on/off, PWM dimming, and color-changing applications. https://www.diodeled.com/custom/download/productFile/filename/VLM-Specification%20Sheet%20(Driver%20&%20J-Box).pdf/ Contains: • Additional Models • Derating Curves • Additional Features • System Diagrams									
VLM60W-24	120 / 277VAC 47 - 63Hz	24V	60W	No Minimum Load	Yes	PWM	5.1 in.	0.75 in.	0.77 in.
VLM60W-24-LPS3R	120 / 277VAC 47 - 63Hz	24V	60W	No Minimum Load	Yes	PWM	10.79 in.	7.34 in.	2.36 in.
VLM100W-24	120 / 277VAC 47 - 63Hz	24V	100W	No Minimum Load	Yes	PWM	5.38 in.	1 in.	0.77 in.
VLM100W-24-LPS3R	120 / 277VAC 47 - 63Hz	24V	100W	No Minimum Load	Yes	PWM	10.79 in.	7.34 in.	2.36 in.

EMERY™ A1 24V

Linear Lighting Fixture

A deep, architectural-grade fixture with an integrated wire raceway.

Date _____

Project Notes _____



CERTIFICATIONS

Safety

- UL Listed 2108 Low Voltage Luminaires. Certified for United States and Canada. File # E469769.
- Approved for storage areas of clothes closets per NEC 410.16.A.3 and 410.16.C.5

Performance

- Can be used to comply with TITLE 24 Part 6 High Efficacy Lighting LED requirements - JA8-2016-2022-E
- LED chip data measured in accordance to IES LM-80-08.
- Photometric & Colorimetry data measured in accordance to IES LM-79-08, in Elemental LED's Innovation Lab.

Safety / Warnings / Disclosures

1. Install in accordance with national and local electrical code regulations.
2. This product is intended to be installed and serviced by a qualified, licensed electrician.
3. Only use copper wiring. Use wires rated for at least 176°F (80°C) and certified for use with external connection of electrical equipment.
4. Tape light, attached wire leads, and additional extension cables, connectors, etc., are not rated for in-wall installation unless otherwise noted. Tape light and attached wire leads are field-cuttable.
5. Ensure applicable wire is installed between driver, fixture, and any controls in-between. When choosing wire, factor in voltage drop, amperage rating, and type (in-wall rated, wet location rated, etc.). Inadequate wire installation could overheat wires, and cause fire.
6. Do not install in environment where LED chips are exposed to direct sunlight as damage to the phosphor will occur.
7. Do not install in environment where excessive heat may exist (ex. close proximity to fireplace, etc.) See Ambient Temperature ratings
8. Do not modify product beyond instructions or warranty will be void.
9. Actual color may vary from what is pictured on this sheet and other print materials due to the limitations of photographic processes.
10. We reserve the right to modify and improve the design of our fixtures without prior notice. We cannot guarantee to match existing installed fixtures for subsequent orders or replacements in regards to product appearance, CCT, or lumen output.

WARRANTY

Limited Warranty

- SS: 12 Year Warranty / VE & STD: 7 Year Warranty

This warranty does not include the additional accessories referenced in this specification sheet. Complete warranty details for fixtures and additional accessories are available at www.diodeled.com/limited-warranty/ within the Policies section. For warranty related questions please contact product support.

Consumer's Acknowledgment

Elemental LED, Inc. stands behind its products when they are used properly and according to our specifications. By purchasing our products, the purchaser agrees and acknowledges that lighting design, configuration and installation is a complex process, wherein seemingly minor factors or changes in layout and infield adjustments can have a significant impact on an entire system. Choosing the correct components is essential. Elemental LED is able to work with the original purchaser to make an appropriate product selection to the extent of the limited information that the customer can provide, but it is virtually impossible for Elemental LED to design a system that foresees every unknown factor. For this reason, this Warranty does not cover problems caused by improper design, configuration or installation issues. Any statement from a Elemental LED employee or agent regarding a customer's bill of goods and/or purchase order is NOT an acknowledgment that the products purchased are designed and configured correctly. The purchase agrees and acknowledges that it is the customer's responsibility to adhere strictly to all information contained in the Product Specification Sheets.

There is often more than one way to design, configure and layout an LED lighting application properly to achieve the same lighting effect. Elemental LED strongly recommends that licensed professionals be used in the design and installation of lighting systems that include Elemental LED products. The specifications include important information that a designer and installer should carefully review and strictly follow. Qualified designers and certified and/or licensed installers, with access to the final installation environment, customer goals, and Elemental LED product specifications can make the requisite decisions appropriate for a successful finished lighting application.

- Lumen value measured in accordance to IES LM-80-08. LED chips have a luminous flux range with a tolerance of +/- 5%.
- Each maximum run requires a dedicated power feed from the driver. Do not extend beyond the recommended maximum run length. Max run may exceed Class 2 limit. Actual wattage may differ from calculated wattage due to voltage drop across run.
- Do not install product in an environment outside the listed ambient temperature. Exceeding the maximum ambient temperature may damage LED chips, reduce the total lamp life, lumen output, and/or adversely impact color consistency.
- Actual efficacy value is dependent to specified LED driver (power supply). An estimated efficacy value can be calculated as follows: Lumen value divided by average power consumption per foot.
- Operating temperature is measured according to the minimum and maximum ambient temperature environment.